

# Parwati TOWERS

SERVING YOU THE WISDOM OF ARCHITECTURE

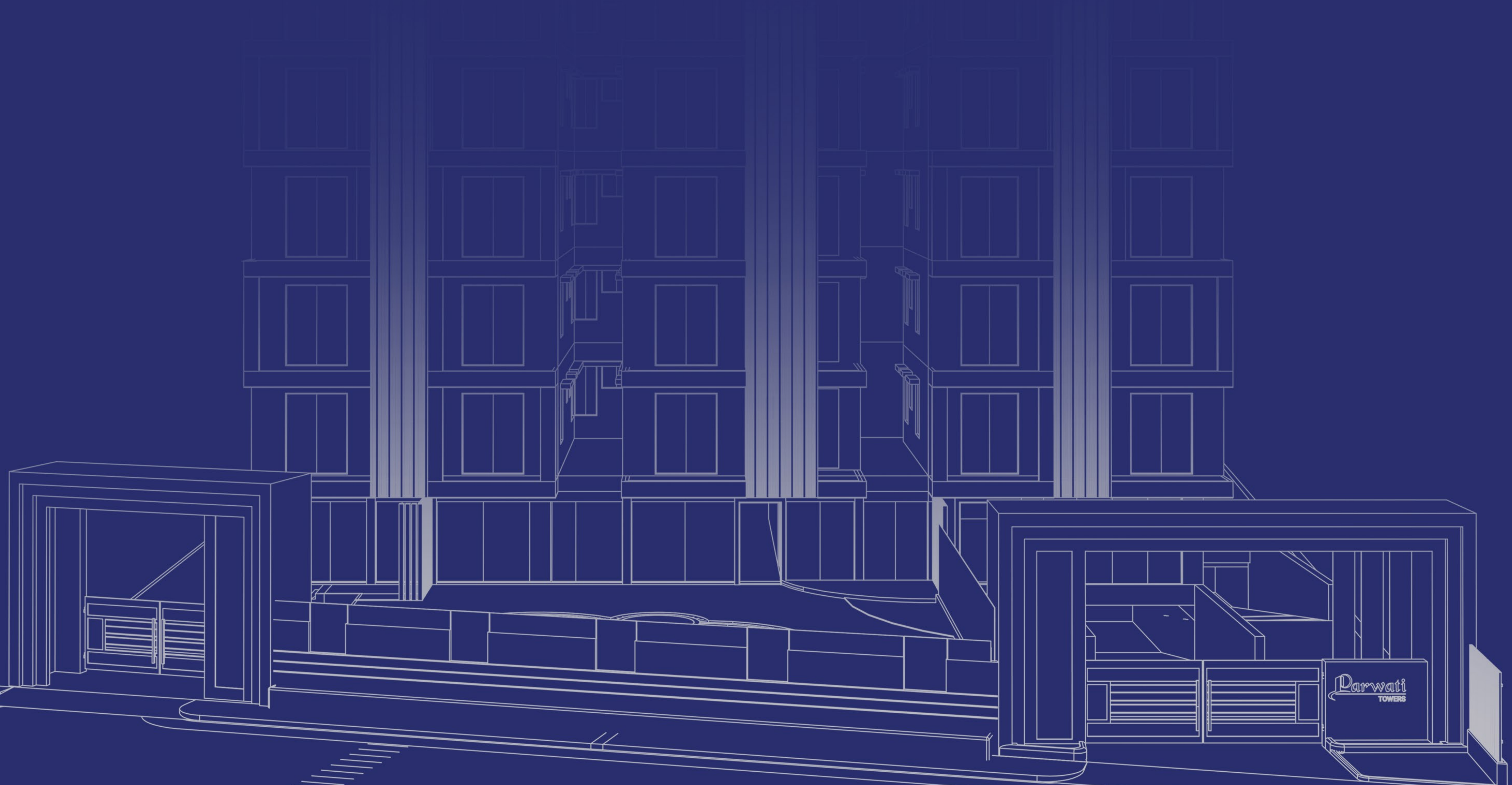

Parwati  
TOWERS

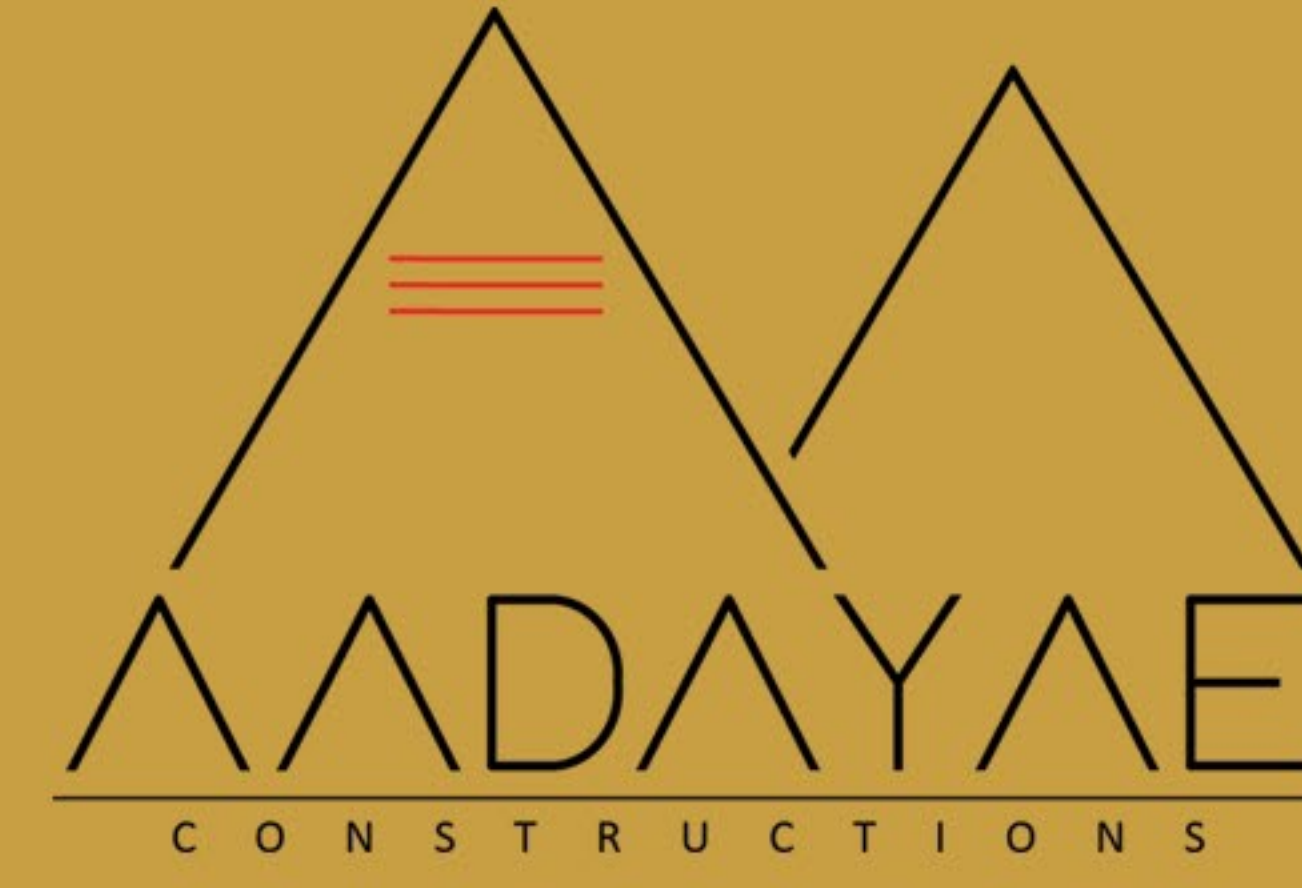

## Aadayae Construction Private Limited

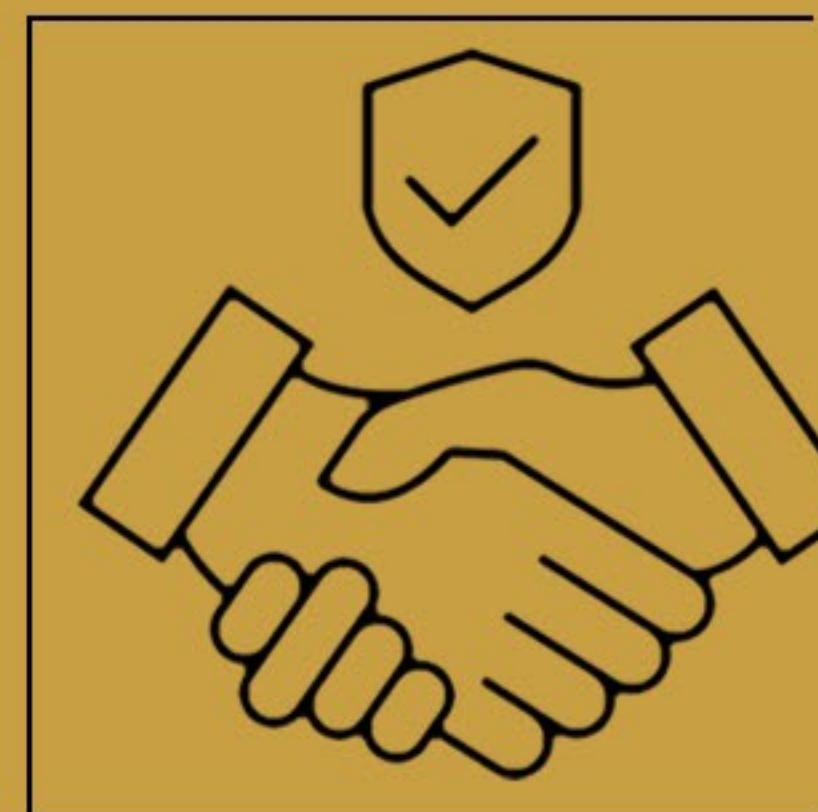

Building Trust Through Perfection

At **Aadayae Construction Private Limited**, we stand among the top builders in Patna and Ranchi, renowned for our perfection and innovation in the real estate development sector. Guided by a team of expert engineers and skilled professionals, we have crafted numerous architectural landmarks that have set new benchmarks for excellence-both for our competitors and for the communities we serve.



Sustainable Construction Excellence

Our expertise spans across a diverse range of projects including duplexes, flats, townships, plotted developments, colonies, and custom-designed structures tailored to our clients' unique requirements. Every project we undertake reflects our core philosophy of customer satisfaction, achieved through eco-friendly, sustainable, and innovative construction practices.



Trusted Name in Real Estate

What sets us apart is our commitment to world-class quality at affordable prices. From humble beginnings, we've grown through integrity, hard work, and excellence. Today, we are a trusted name in the regional real estate market. With projects across Patna and Ranchi, we continue to redefine urban living. Every development ensures quality, comfort, trust, and long-term value.



Building Dreams for Generations

Our journey in the real estate industry began in the early 1960s, when our visionary grandfather, Late Mr. Krishna Mahto, laid the foundation of our legacy from Gola Road, Patna, Bihar.

Since then, we have proudly carried forward his dream - creating modern, luxurious, and innovative spaces for families and entrepreneurs alike.

Over the decades, we've served diverse sections of society - from farmers and landowners to government officials, cooperative societies, businessmen, and investors.

Our commitment to perfection and transparency has made us one of the most trusted names in real estate and development in Patna.

With every project, we blend advanced technology, expert engineering, and timeless craftsmanship to uphold the tradition of quality passed down through generations.

Backed by the trust of our valued clients, we continue to build not just properties, but lasting relationships.



Innovation That Builds Futures

At **Aadayae Real Estate**, our management and team work with unwavering dedication to deliver premium, high-quality real estate solutions across the nation. Whether for residential, commercial, or investment purposes, we help individuals and businesses find properties that match their vision and goals.

Our expertise spans the development of duplexes, flats, plots, colonies, and large-scale townships - all customized to meet our clients' unique requirements. With a focus on sustainability, innovation, and eco-friendly design, our mission is simple yet powerful: to build trust, create lasting value, and achieve complete customer satisfaction in every project we undertake.



## Why Parwati Towers

### WAKE UP TO ABUNDANCE OF LIGHT

Residences are masterfully aligned to the sun — flooding your home with natural light that elevates mood, energy, and everyday living.

### BREATHE THE DIFFERENCE

Large sized, Dual-aspect windows create effortless cross-ventilation — bringing in fresh air, cooling your space naturally, and redefining what comfort truly feels like.

### POWERED BY POSITIVITY

Meticulously Vastu-aligned homes designed to attract harmony, success, and well-being — because where you live should empower how you live.

### INDULGENCE, EVERY SINGLE DAY

From tranquil yoga decks and meditation zones to multipurpose sports court a modern fitness center, elegant community hall, open lawns, and a stunning swimming pool — every moment here feels like a getaway.

### GRAND, SPACIOUS LIVING

Thoughtfully designed expansive layouts with generous room sizes — giving you the freedom to live, host, and unwind without limits.

### LUXURIOUS BATH SPACES

Spacious, elegantly designed bathrooms with premium fittings — your personal sanctuary of comfort and indulgence.

### ELEVATED CEILING HEIGHTS

Airy interiors with enhanced ceiling heights — creating a sense of openness, volume, and architectural grandeur.

### DESIGNED FOR PRIVACY

Well-planned residences with minimal shared walls and smart layouts and well placed windows— ensuring peace, exclusivity, and uninterrupted living.

### ICONIC ENTRANCE & LOBBY

Make an impression from the moment you arrive — grand entrance and elegantly designed lobby spaces that set the tone for luxury.

### WATER SECURITY. ZERO COMPROMISE.

Round-the-clock water supply backed by advanced underground storage systems — because true luxury means never worrying about the essentials.

### INDULGENCE, EVERY SINGLE DAY

From tranquil yoga decks and meditation zones to multipurpose sports court a modern fitness center, elegant community hall, open lawns, and a stunning swimming pool — every moment here feels like a getaway.

### PREMIUM FINISHES & MATERIALS

From high-quality flooring to quality fixtures — every detail reflects sophistication and lasting quality.

### SECURE & SMART LIVING

Advanced security systems with CCTV surveillance and controlled access — offering complete peace of mind for you and your family.

### AMPLE PARKING SPACES

Well-organized, spacious parking designed for convenience — because every detail of your lifestyle matters.





ARTIST'S  
ARCHITECTURAL  
FRONT LOOK



Parwati  
TOWERS



  
ARTIST'S  
AERIAL  
IMPRESSION

## Sky Lounge & Rooftop Experiences

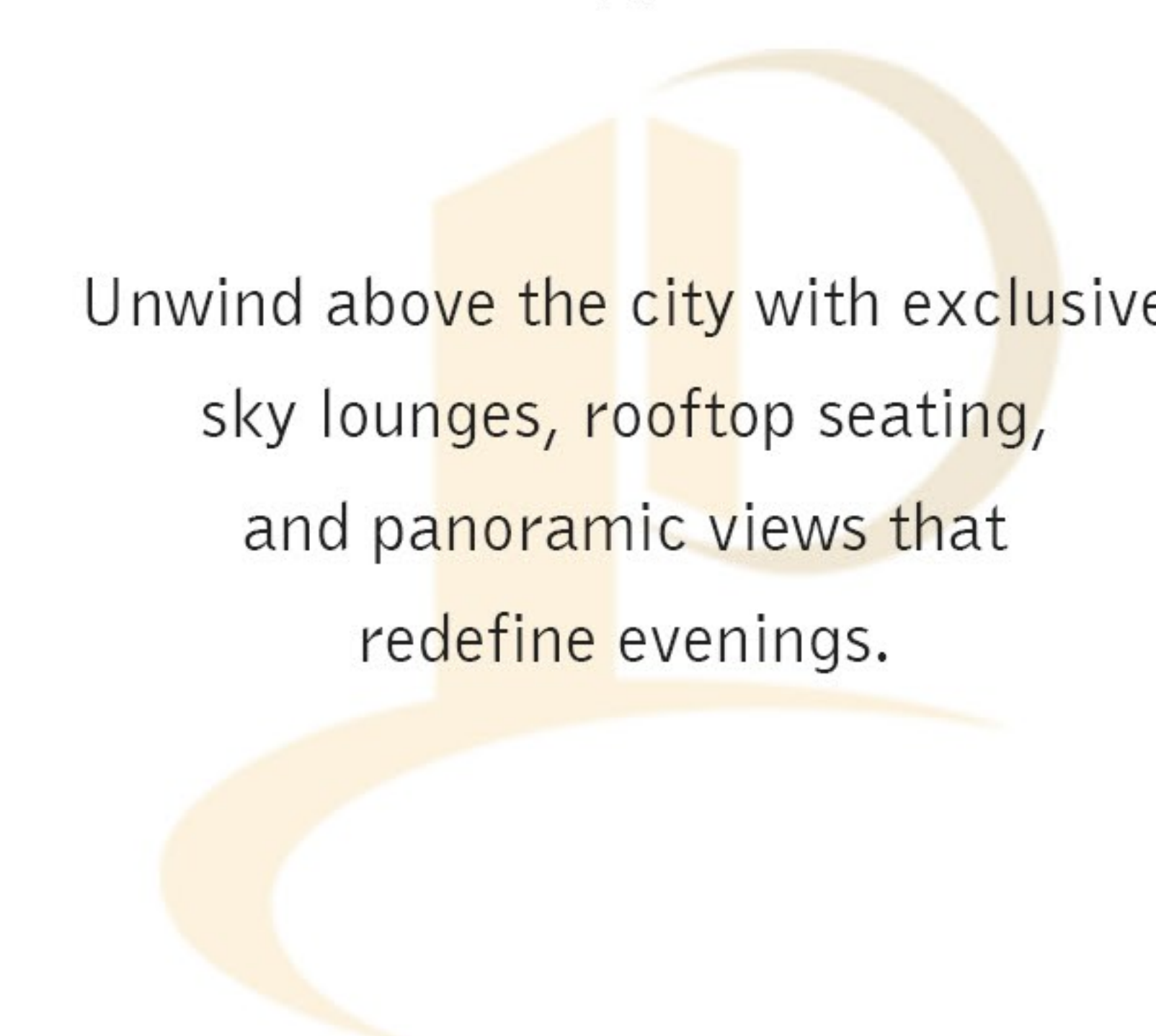

Unwind above the city with exclusive sky lounges, rooftop seating, and panoramic views that redefine evenings.





## The Perfect First Impression

A graceful combination of sleek architecture, ambient lighting, and a serene pool creates an unforgettable arrival.  
This is where contemporary design meets everyday luxury.

## Project Specifications

### STRUCTURE

B+G+6 (Six) Floor R.C.C. Frame Structure as per drawing & design with earthquake resistant.

### FINISHING

All internal walls finish with plaster of paris and exterior surface with weather coat with cement base paint from reputed company.

### WINDOWS

Aluminium / UPVC sliding windows.

### KITCHEN

Provision of granite platform with dado of glazed tiles upto 2ft. height & one steel sink.

### P.H.E. WORK

Common water tank for the block. Each toilet finished with geyser point, washbasin, I.W.C. or E.W.C. pan with cistern and all TDP fittings of C.P. of standard make Jal all sanitary Euro will be done with PVC & CPVC Astral pipes all water connection with ISI approved. Gland PVC pipe and fittings.

### PLASTER

15mm and 18mm plaster in CM 1:6 on RCC source and brick surface.

### CIVIL WORK

First Quality black work in cement, sand mortar as per thing & design.



### FLOORING

Vitrified tiles.  
Marble flooring in Stair.  
Checked tiles in parking space.

### DOORS

Main Door: 8 feet flush door in laminate finish with wooden frame.

Internal Doors: 7 feet Hardwood / WPC frames with Paint finish Shutter.

### TOILET

White / Printed glazed tiles upto 8ft. height bathroom fittings of standard make.

### ELECTRICAL

Concealed PVC conduit with copper wiring with Anchors fittings or equivalent make with adequate light and power points in Bed rooms, kitchen, both toilet and dinning space. Provision of exhaust point is kitchen & toilet of exhaust point in kitchen & toilet.

### OTHER FEATURE

Boring will be fitted with submersible pump as per design. One Wash basin in dinning space.

### OTHER CHARGES

Lift, Parking, Generator & Amenities





A serene, beautifully crafted temple within the premises — offering a peaceful sanctuary for daily prayers, reflection, and spiritual well-being.

# Ground Floor Plan



Block - A Floor Plan  
G+1st to G+6th Floor

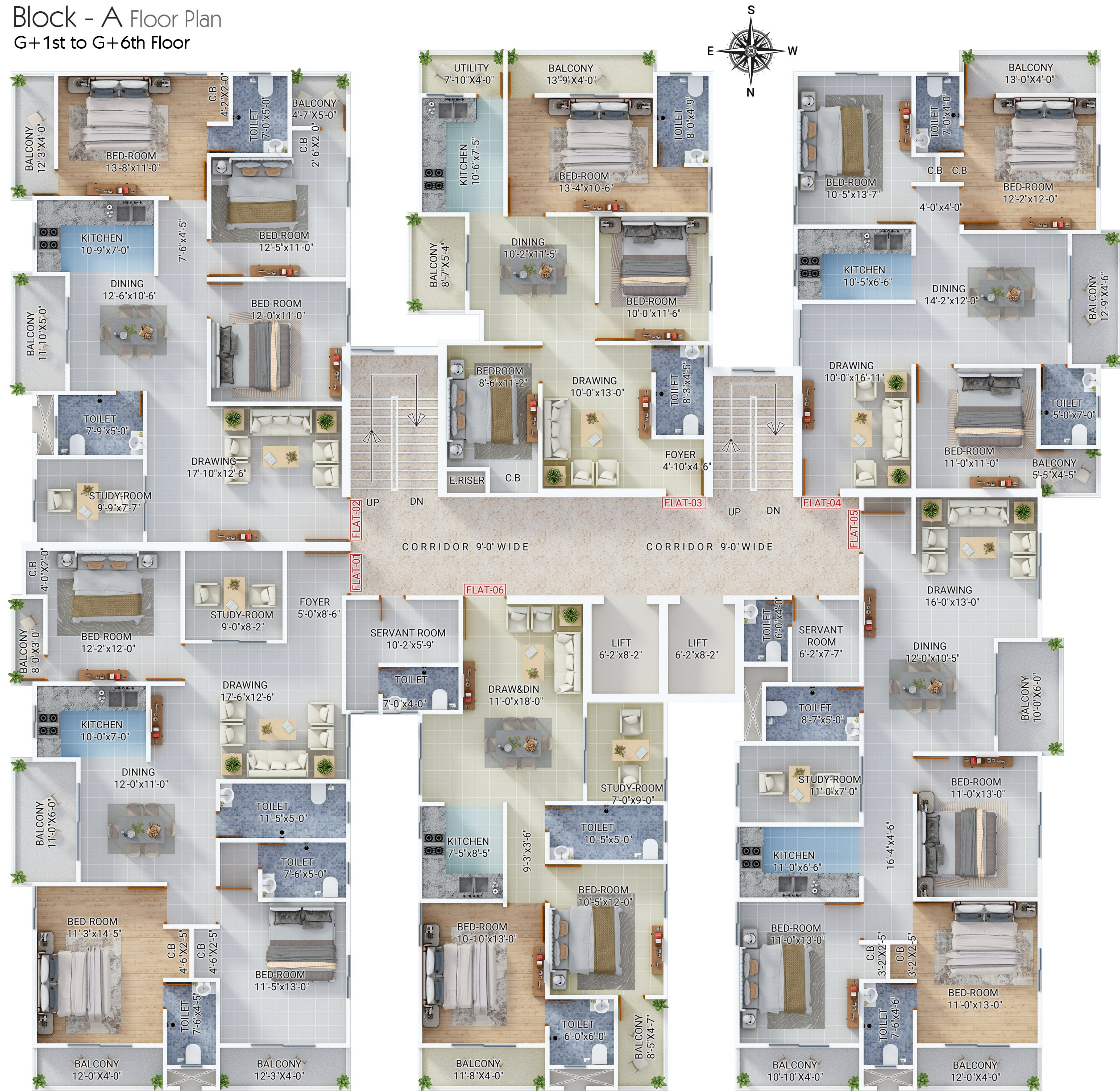

Block - A | G+1 to G+6 Floor Plan Area

Flat Type	- 01
Unit	- 4.5-BHK
Built-up Area	- 1603.0 Sq.Ft.
Super Built-up Area	- 2083.0 Sq.Ft.
Servent Room	- 139.0 Sq.Ft.

Flat Type	- 04
Unit	- 3-BHK
Built-up Area	- 1041.0 Sq.Ft.
Super Built-up Area	- 1353.0 Sq.Ft.

Flat Type	- 02
Unit	- 3.5-BHK
Built-up Area	- 1304.0 Sq.Ft.
Super Built-up Area	- 1695.0 Sq.Ft.

Flat Type	- 05
Unit	- 4.5-BHK
Built-up Area	- 1437.0 Sq.Ft.
Super Built-up Area	- 1868.0 Sq.Ft.
Servent Room	- 88.0 Sq.Ft.

Flat Type	- 03
Unit	- 3-BHK
Built-up Area	- 1050.0 Sq.Ft.
Super Built-up Area	- 1365.0 Sq.Ft.

Flat Type	- 06
Unit	- 2.5-BHK
Built-up Area	- 921.0 Sq.Ft.
Super Built-up Area	- 1197.0 Sq.Ft.

Block - B Floor Plan  
G+1st to G+6th Floor



Block - B | G+1 to G+6 Floor Plan Area

Flat Type	- 01
Unit	- 3-BHK
Built-up Area	- 1127.0 Sq.Ft.
Super Built-up Area	- 1465.0 Sq.Ft.

Flat Type	- 02
Unit	- 3-BHK
Built-up Area	- 1099.0 Sq.Ft.
Super Built-up Area	- 1428.0 Sq.Ft.

Flat Type	- 03
Unit	- 3-BHK
Built-up Area	- 903.0 Sq.Ft.
Super Built-up Area	- 1173.0 Sq.Ft.

Flat Type	- 04
Unit	- 3-BHK
Built-up Area	- 1097.0 Sq.Ft.
Super Built-up Area	- 1426.0 Sq.Ft.

Flat Type	- 05
Unit	- 3-BHK
Built-up Area	- 1149.0 Sq.Ft.
Super Built-up Area	- 1493.0 Sq.Ft.

Flat Type	- 06
Unit	- 2-BHK
Built-up Area	- 814.0 Sq.Ft.
Super Built-up Area	- 1058.0 Sq.Ft.

Isometric View | Block - A



Block-A | Flat - 01 | 4.5-BHK

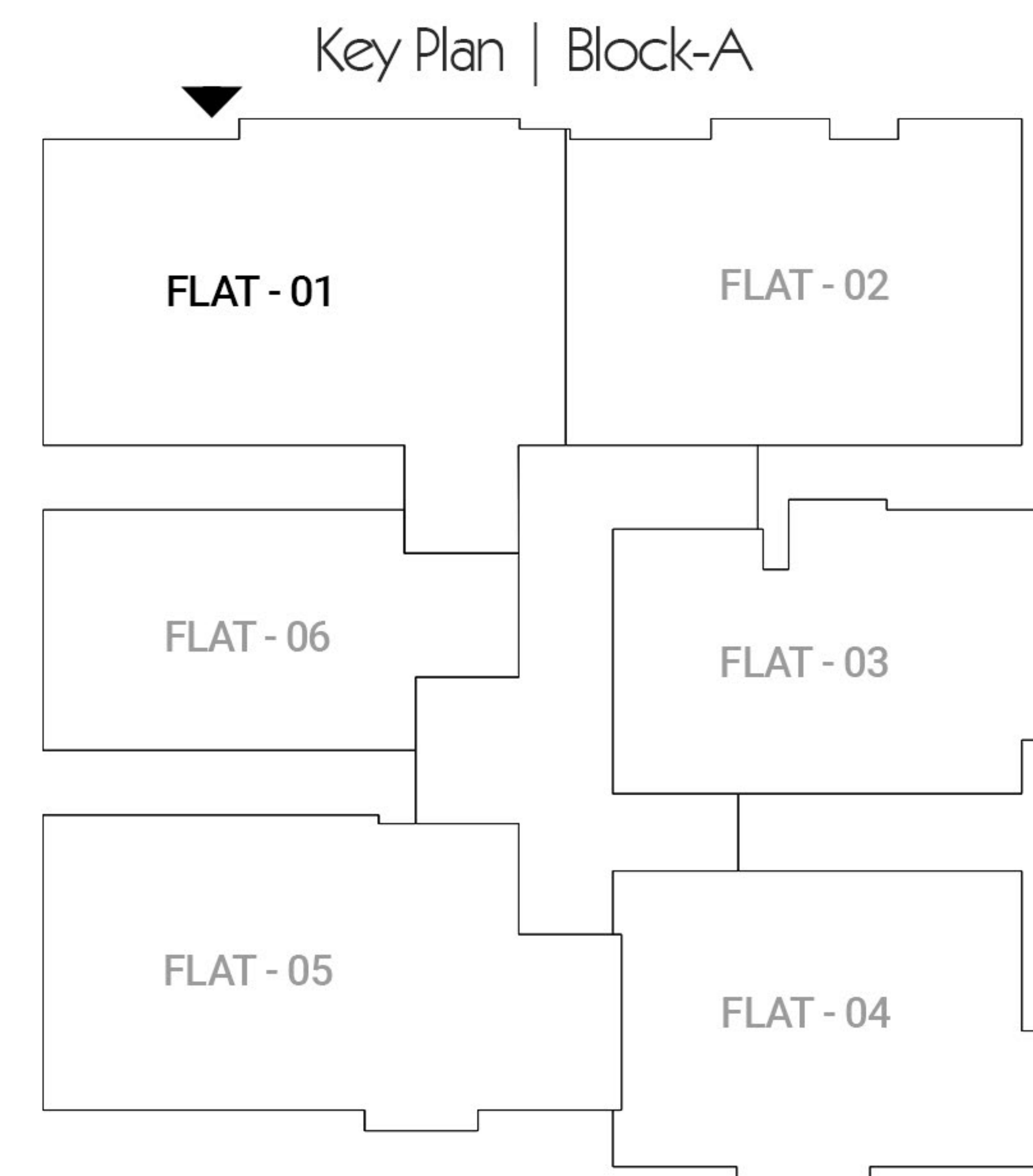

Isometric View | Block - A



Block-A | Flat - 03 | 3-BHK

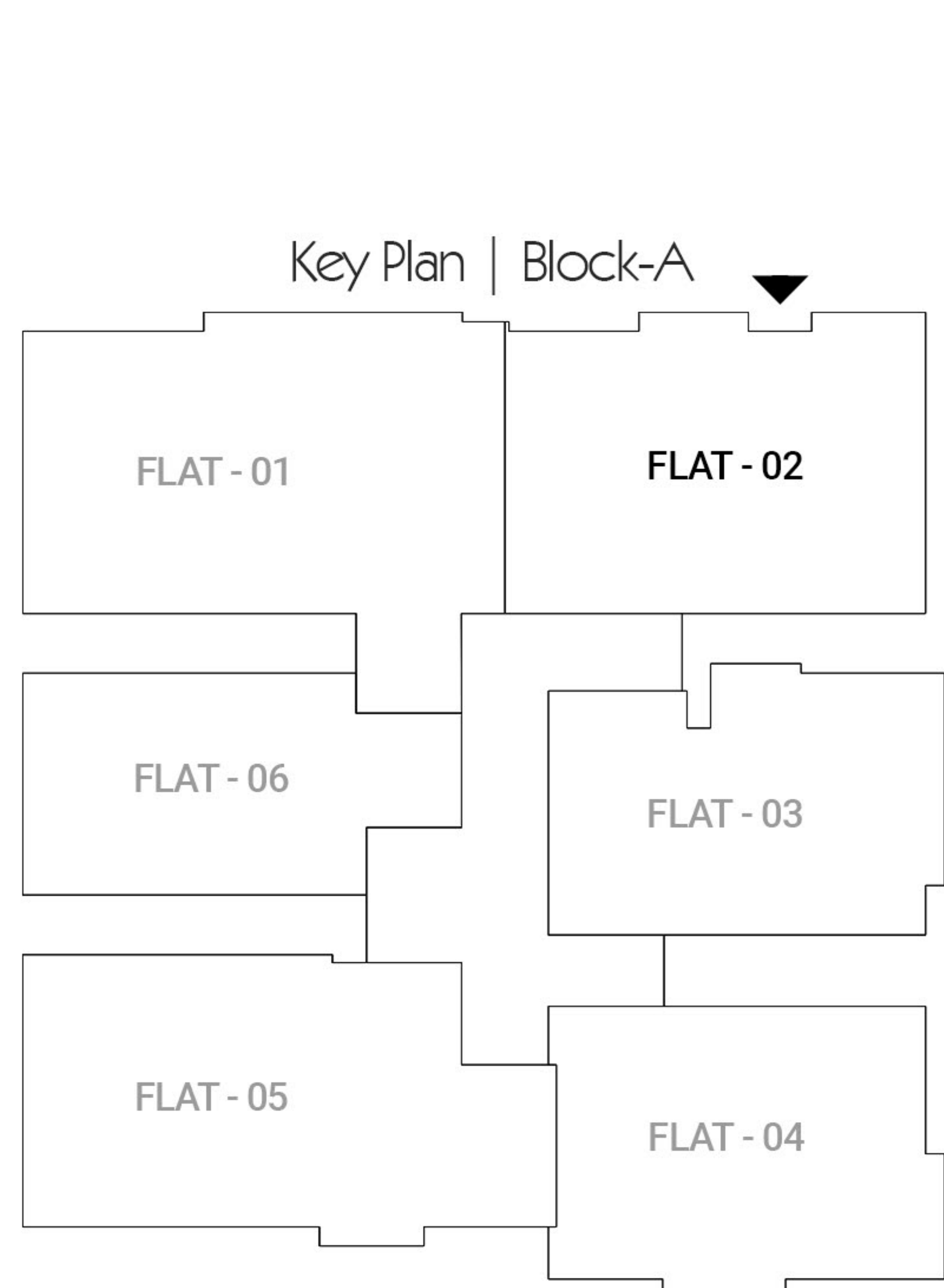
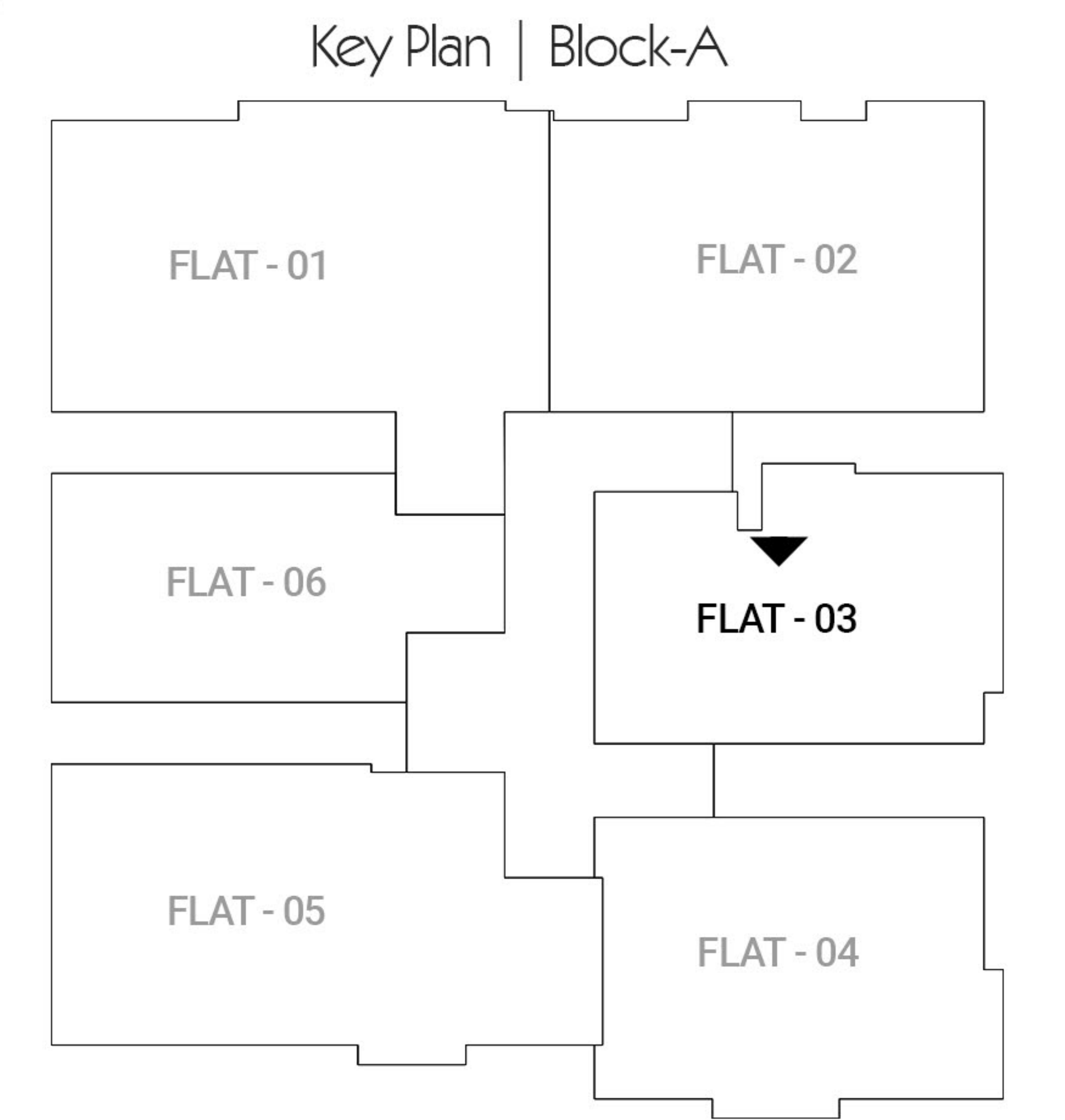

Block-A | Flat - 02 | 3.5-BHK

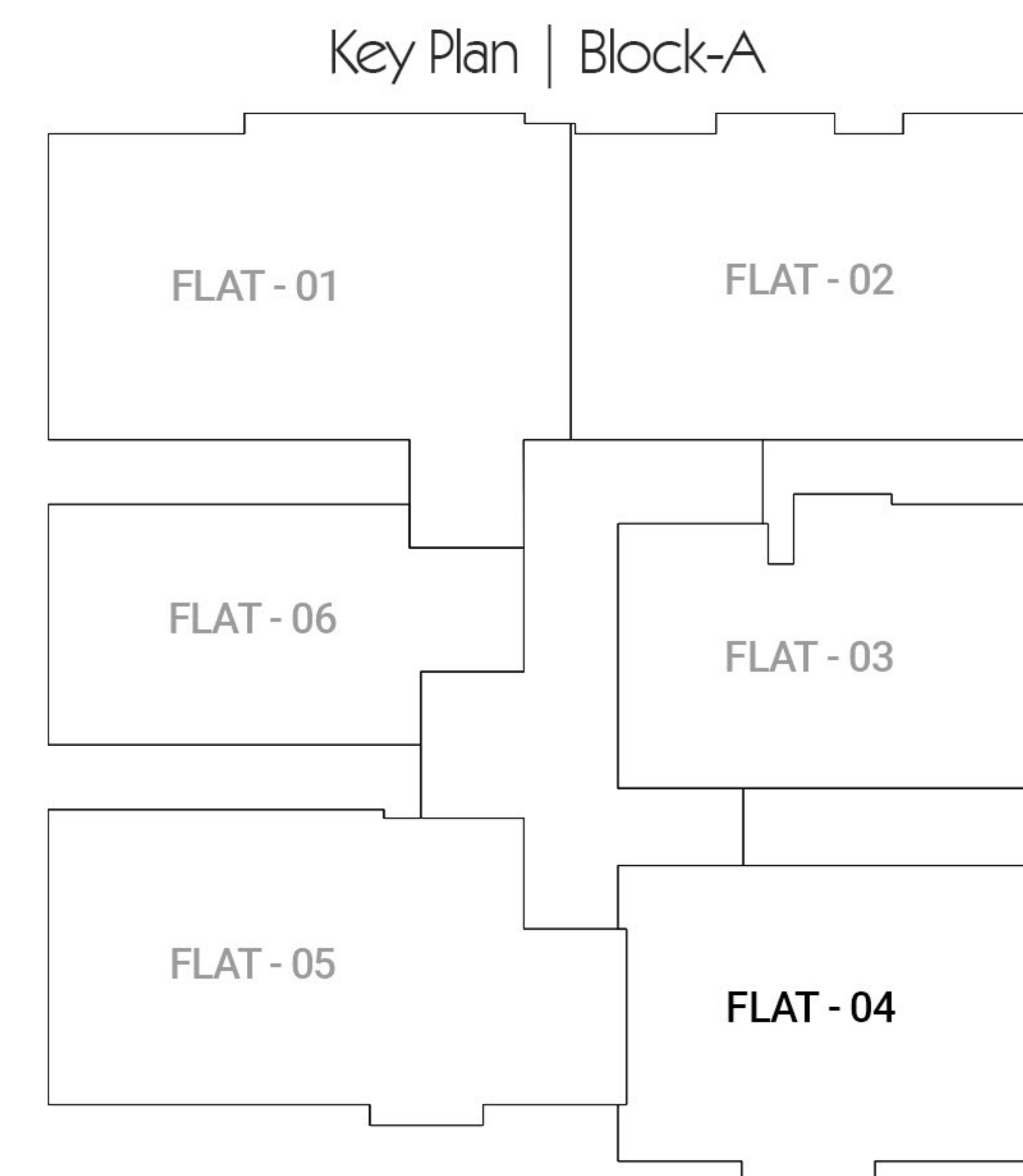

Block-A | Flat - 04 | 3-BHK

Isometric View | Block - A



Block-A | Flat - 05 | 4.5-BHK

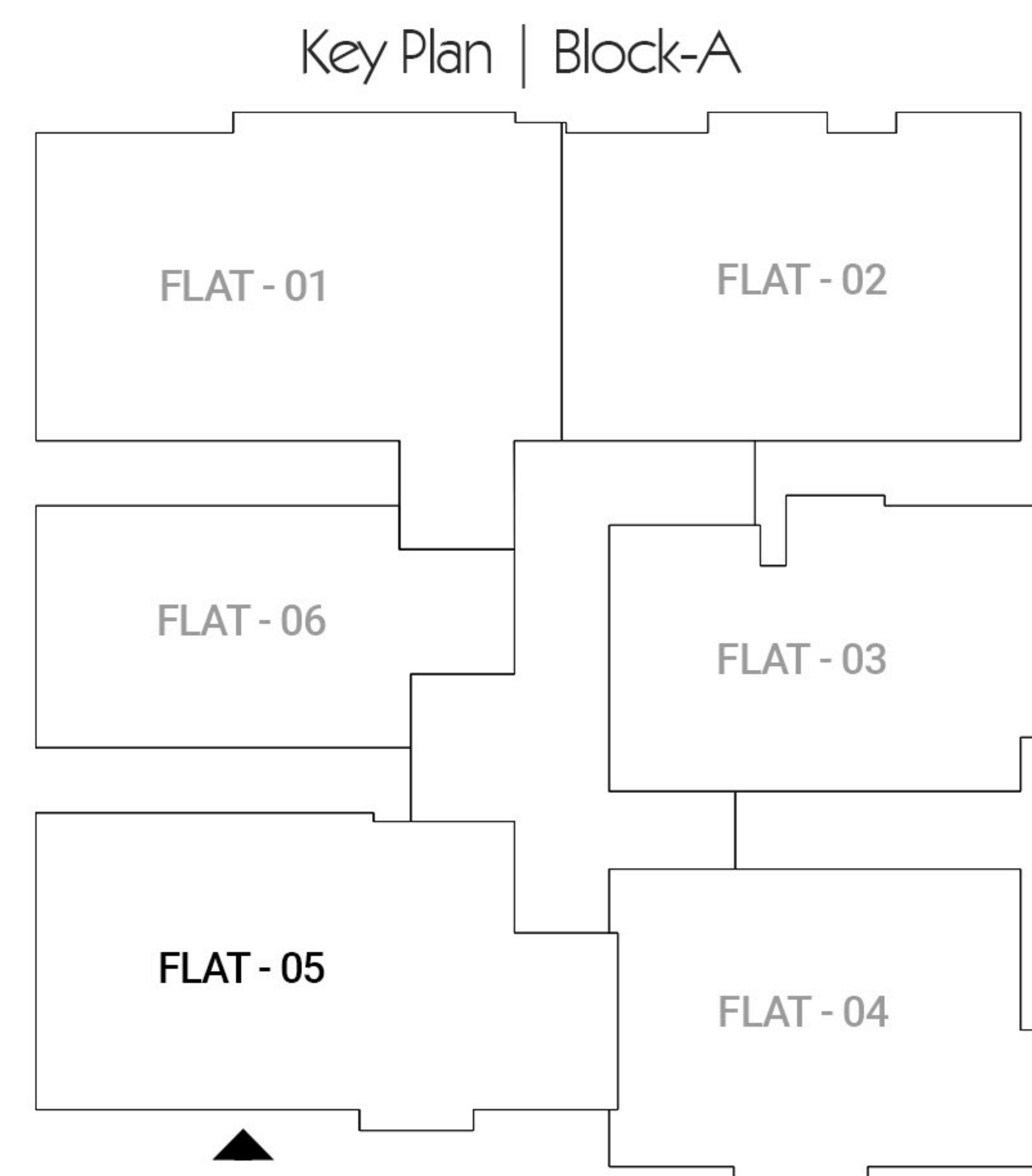

Isometric View | Block - B



Block-B | Flat - 01 | 3.5-BHK

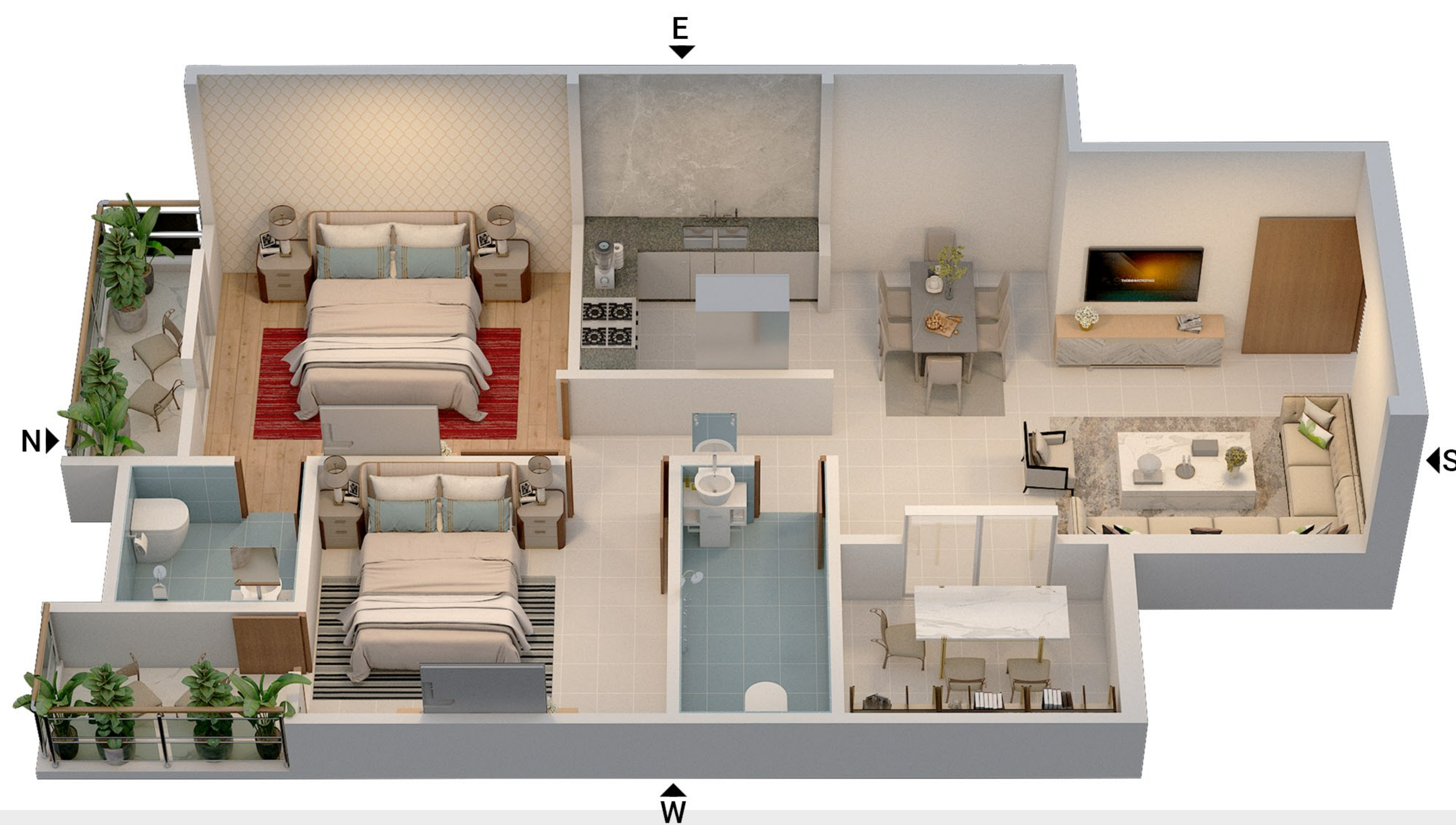
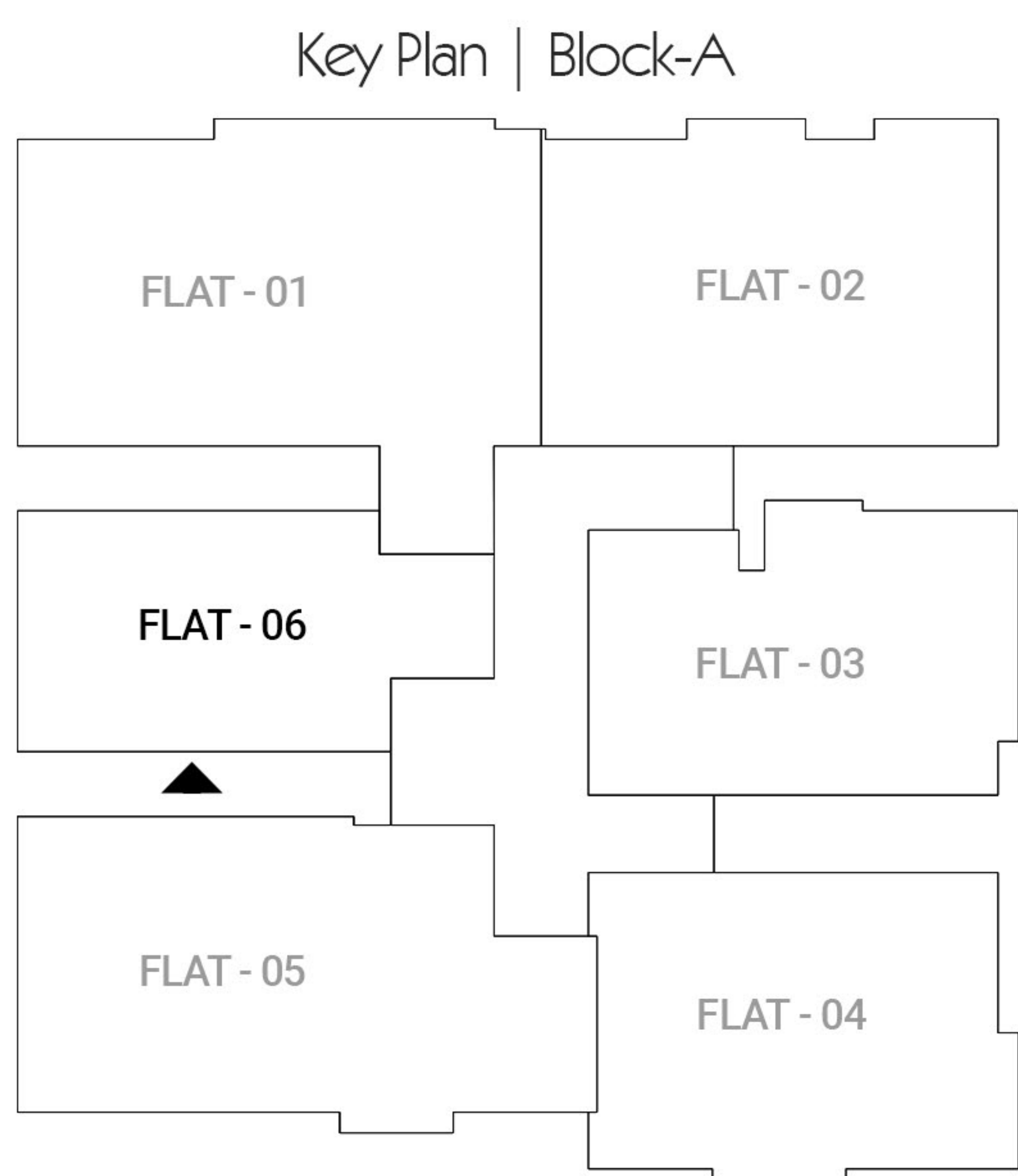
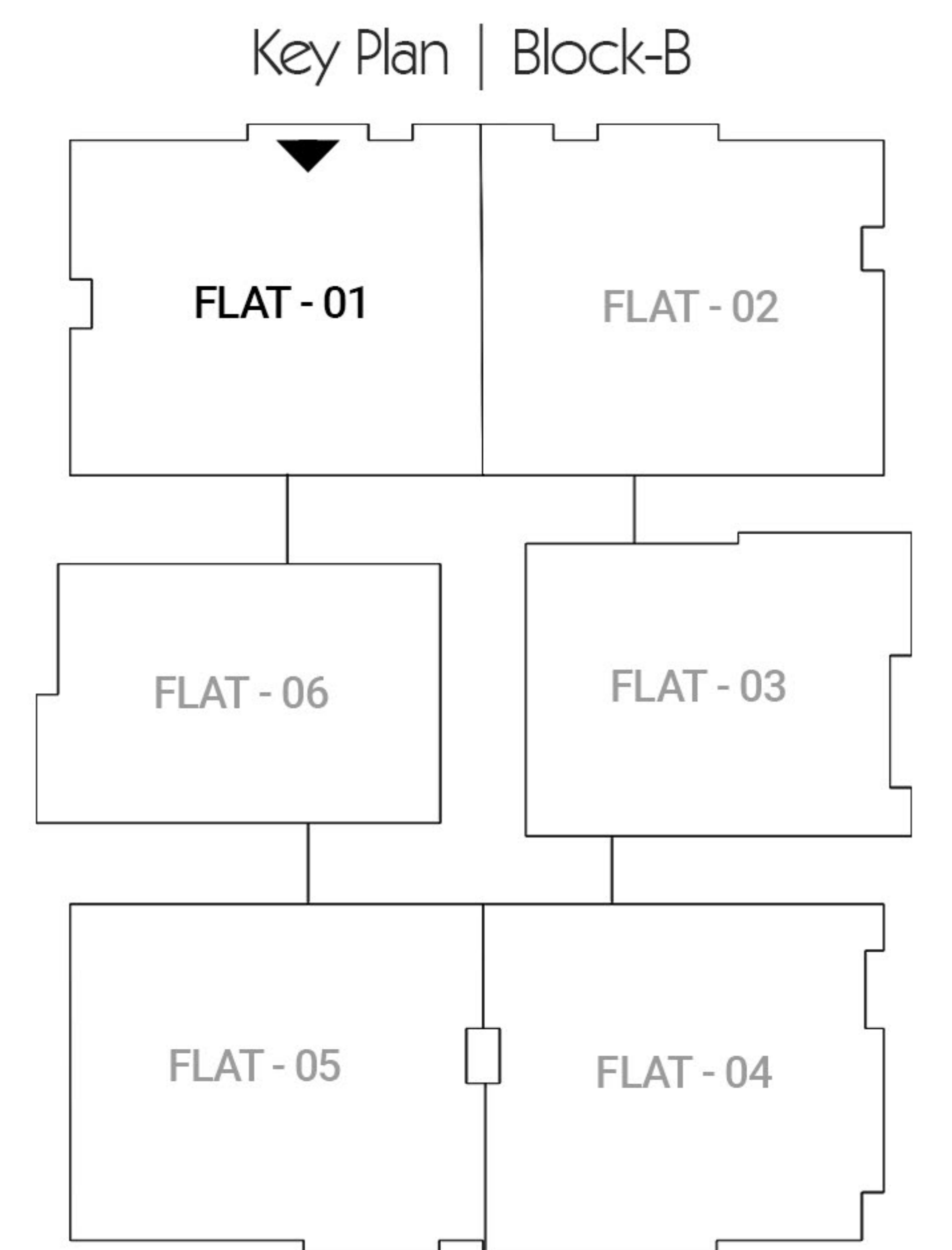

Block-A | Flat - 06 | 2.5-BHK

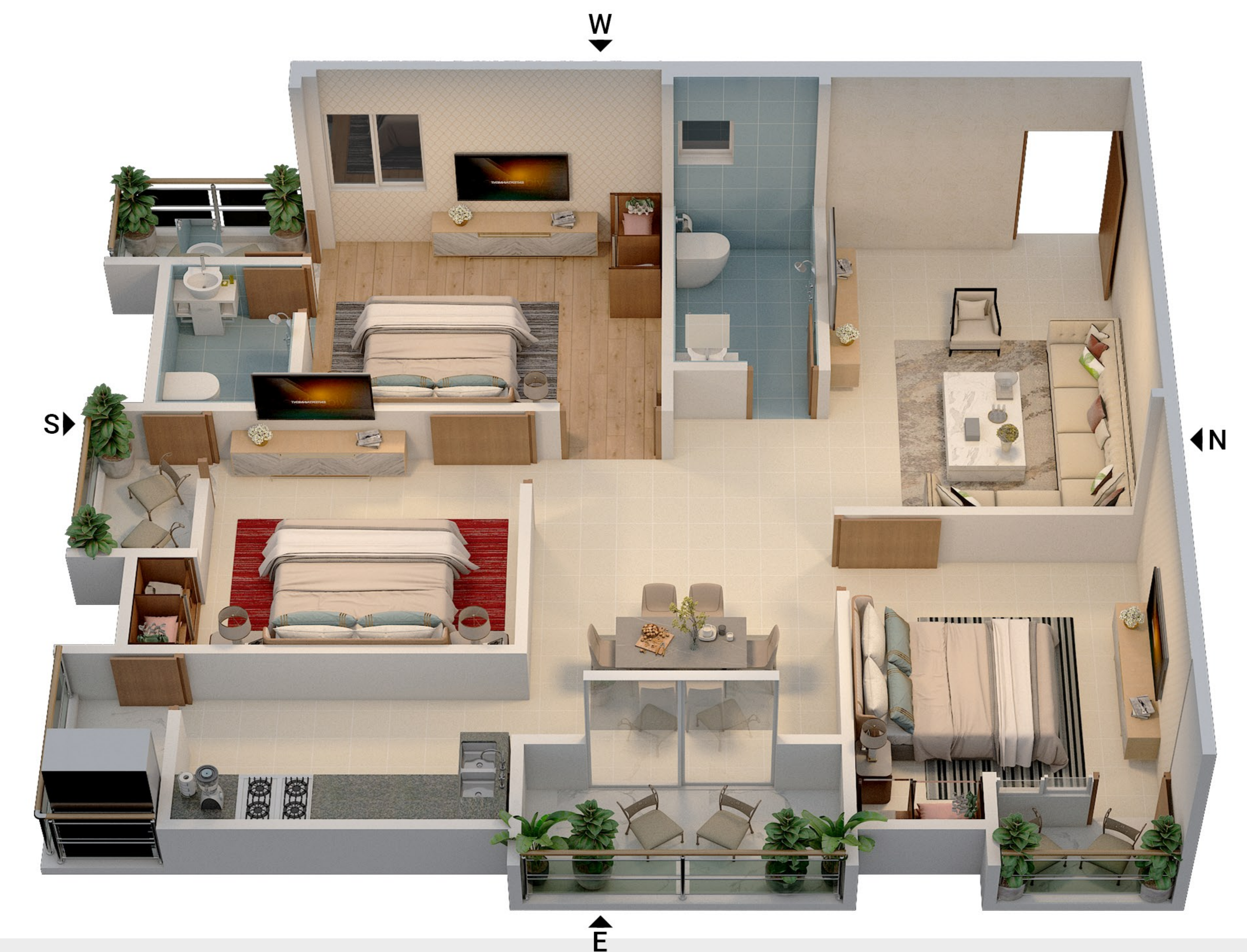
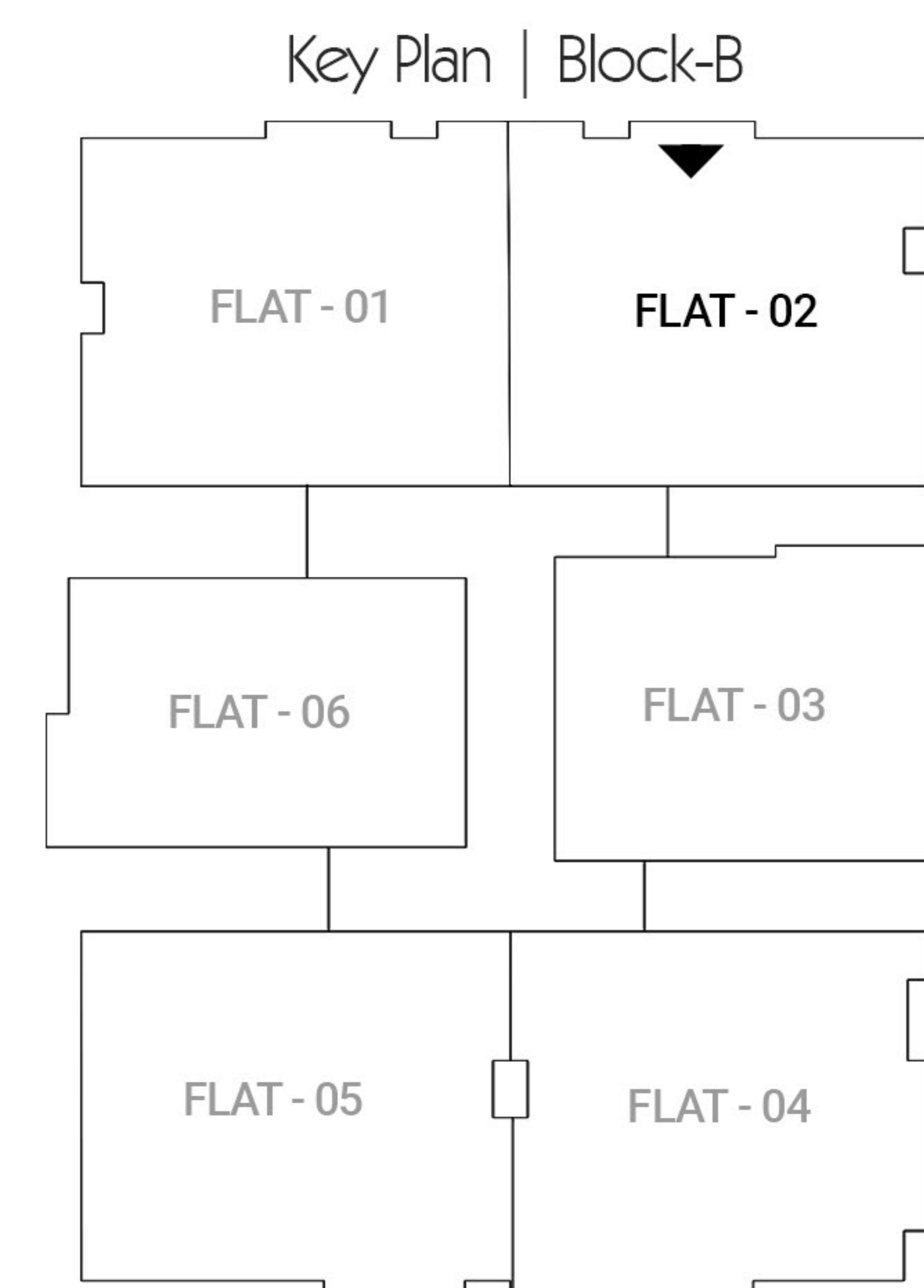

Block-B | Flat - 02 | 3-BHK

Isometric View | Block - B



Block-B | Flat - 03 | 3-BHK

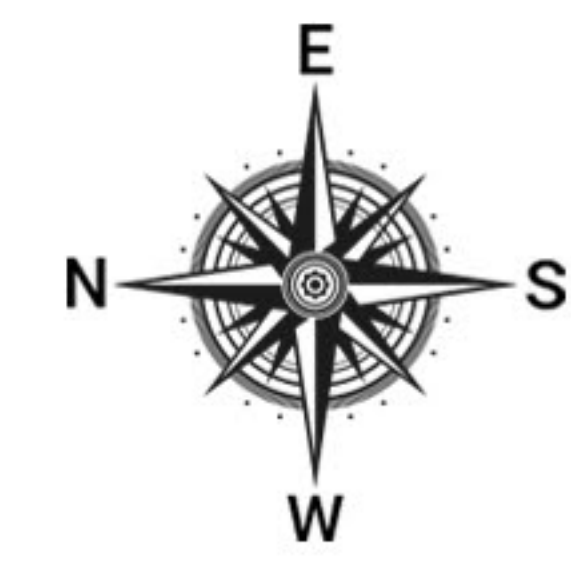

Key Plan | Block-B

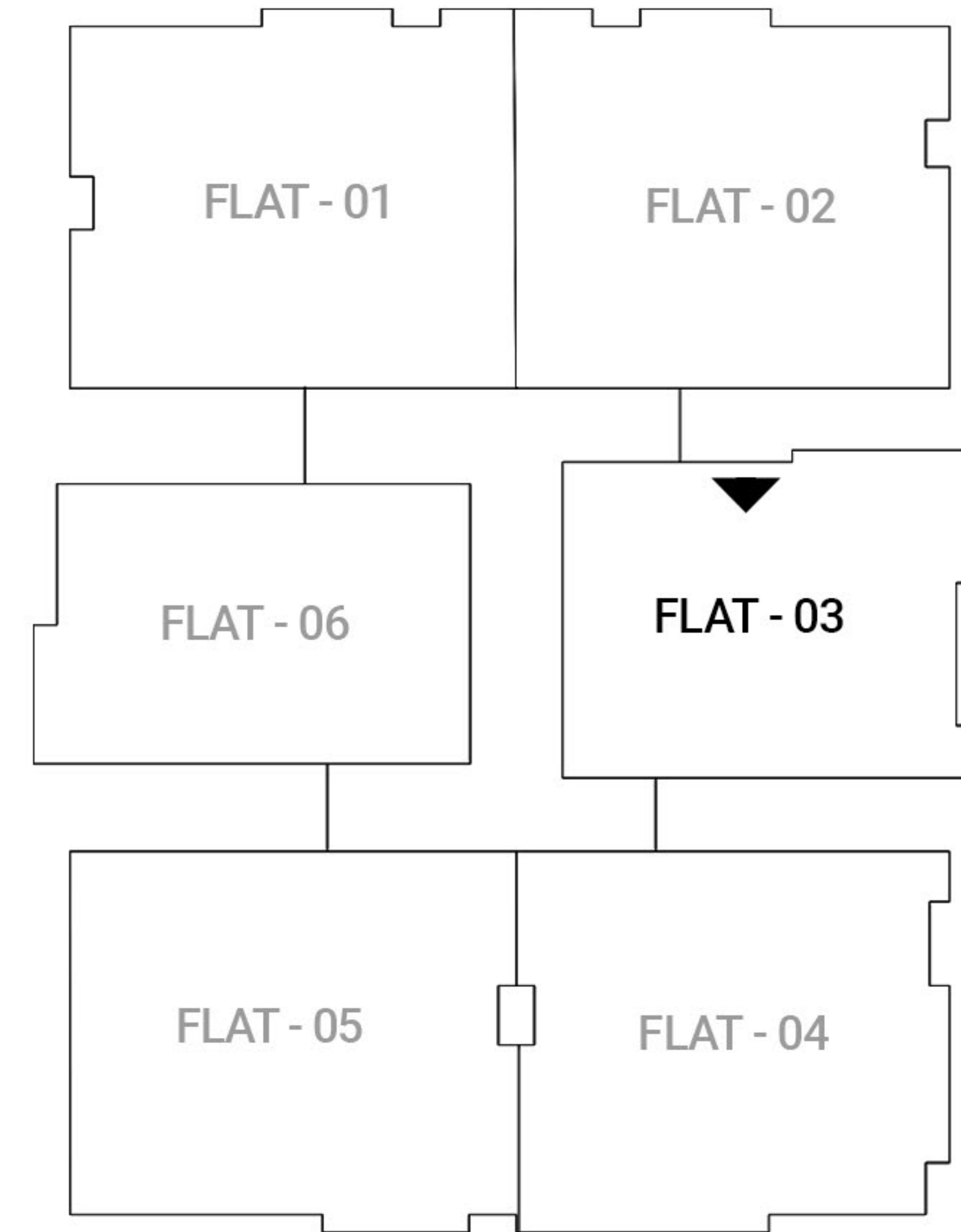

Isometric View | Block - B



Block-B | Flat - 05 | 3-BHK



Key Plan | Block-B

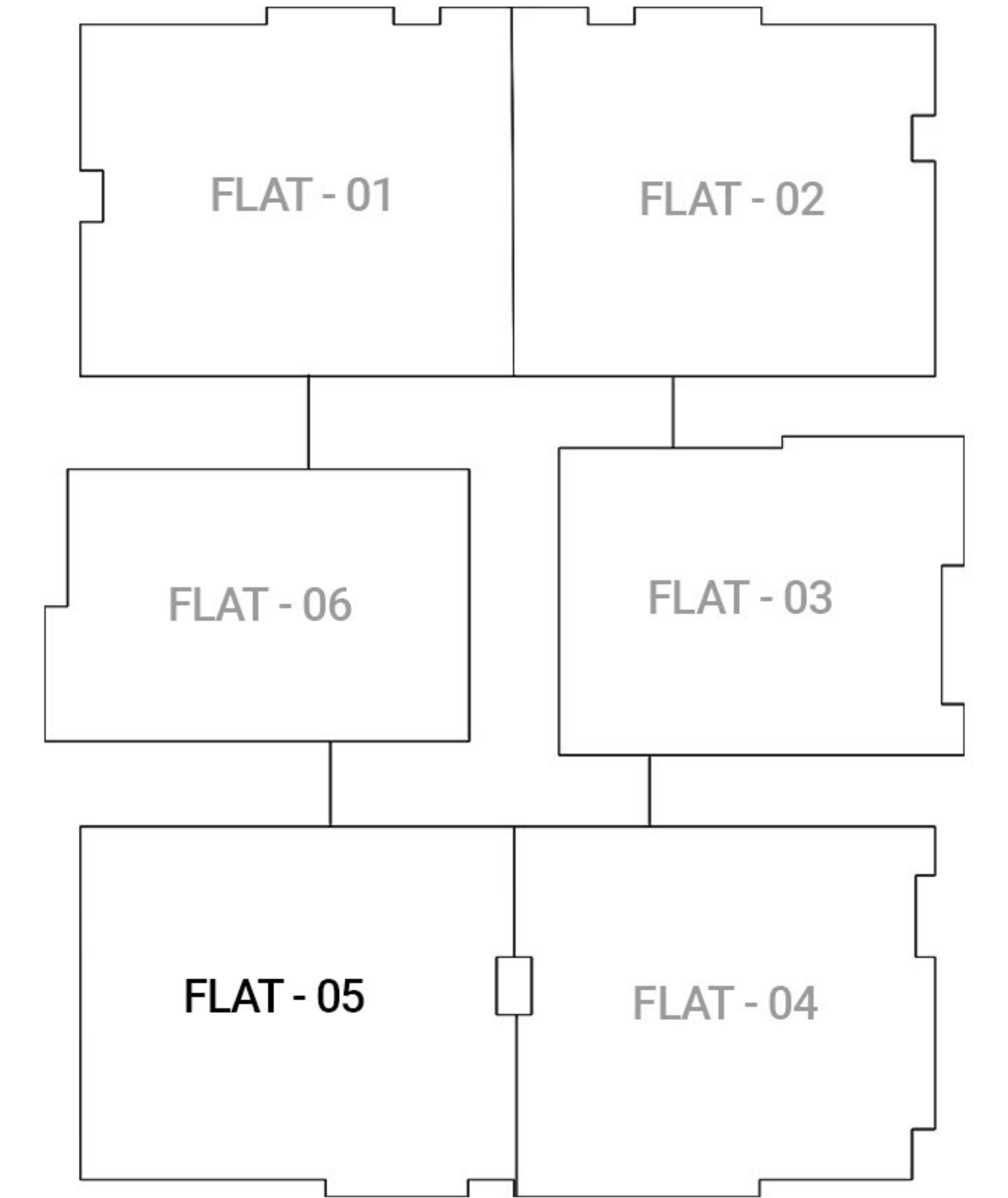

Key Plan | Block-B

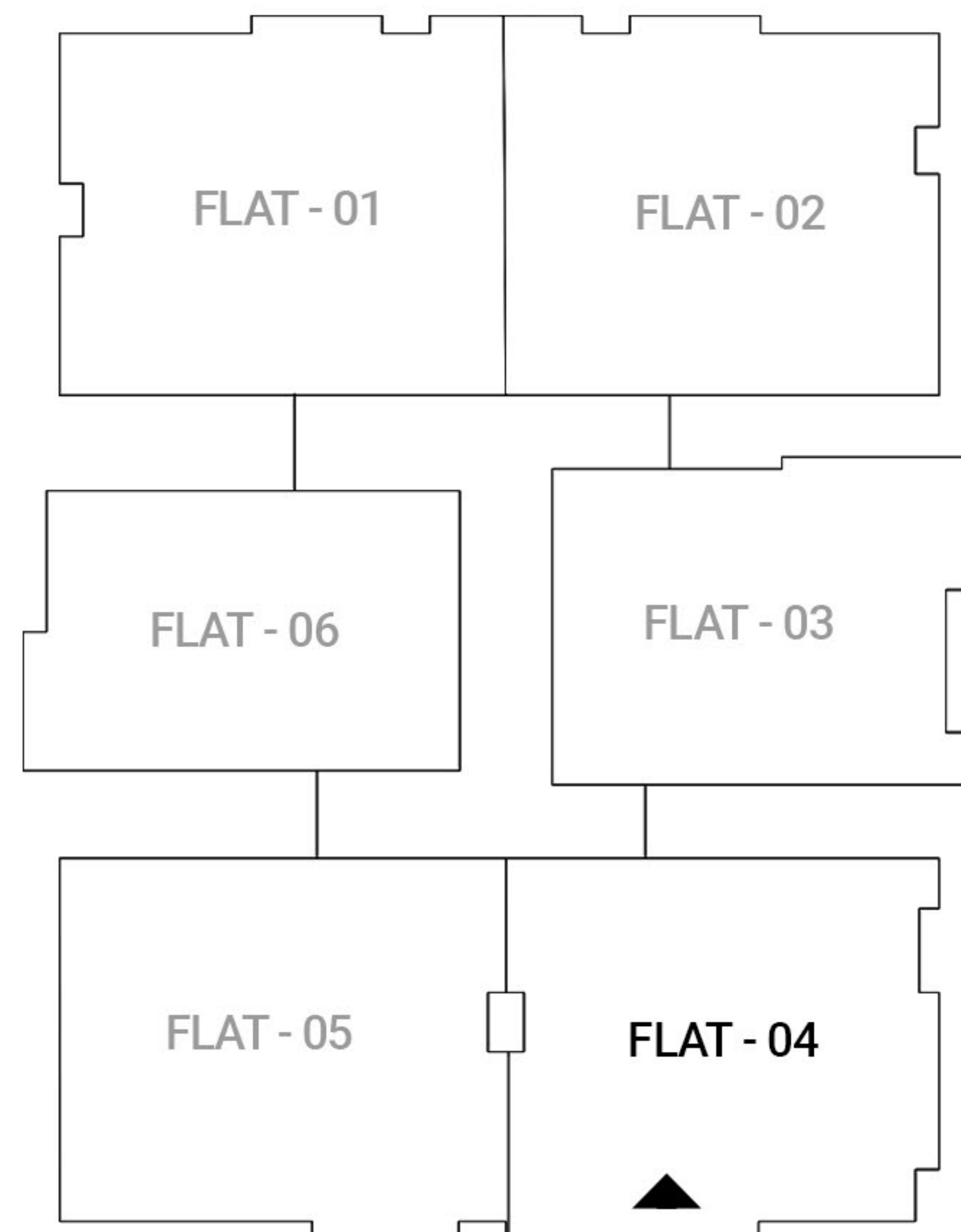

Block-B | Flat - 04 | 3-BHK



Key Plan | Block-B

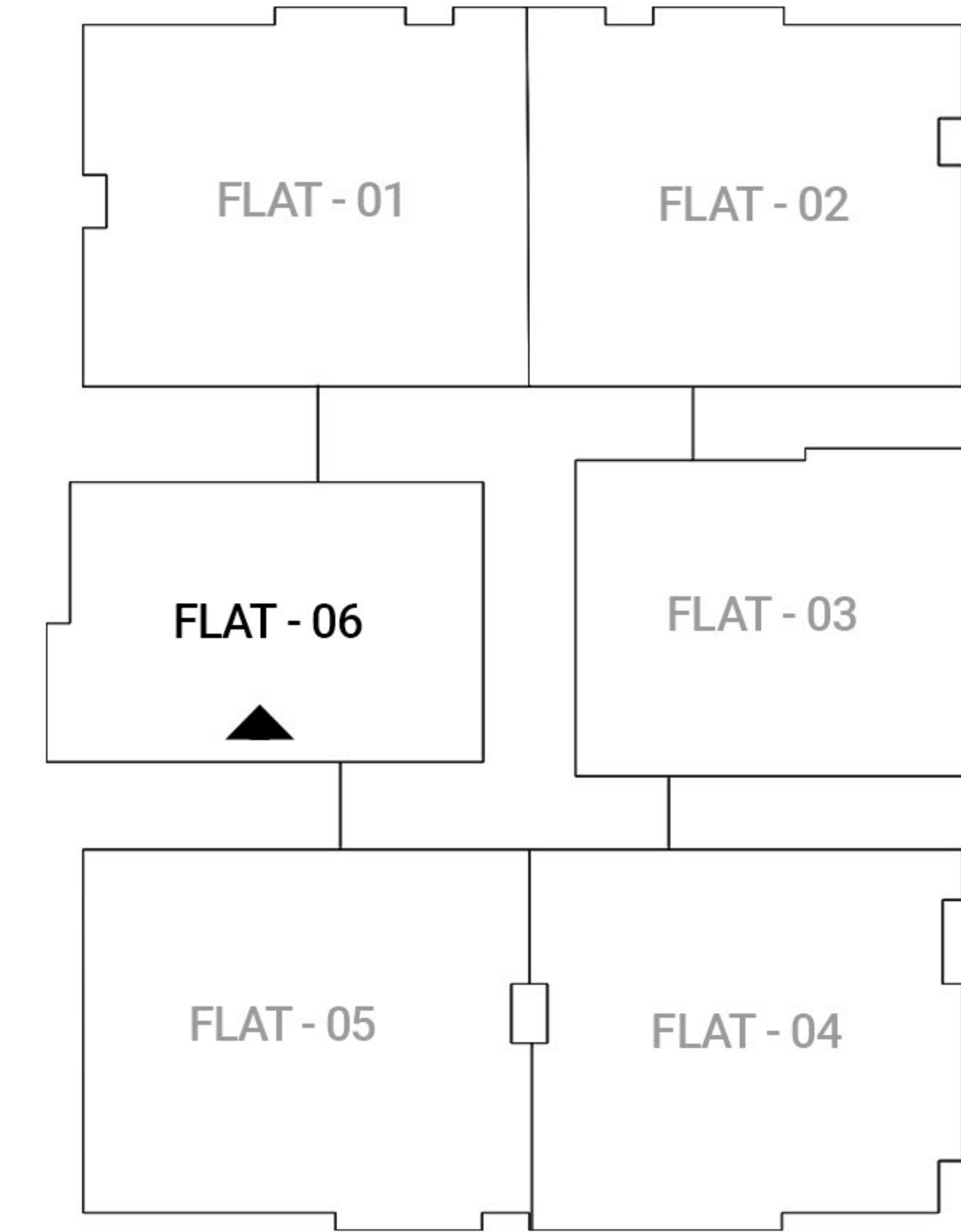

Block-B | Flat - 06 | 2-BHK





Artistic  
Architectural  
Entry View



### Location Highlights

- SCHOOL 1.9 KM.
- HOSPITAL 1.8 KM.
- COLLEGE 150 MTRS.
- SHOPPING MALL-3.1 KM.
- BUS STAND 3.1 KM.
- MARKET 2.7 KM.
- RAILWAY STN. 3.5 KM.
- AIRPORT 20.1 KM.
- POLICE STN. 2.8 KM.

### Site Connectivity Map

This location map highlights the excellent connectivity and convenience offered by the project. Essential facilities such as schools, hospitals, markets, and shopping malls are located within a short distance. Major transport points including the bus stand, railway station, and airport are easily accessible. The map also shows nearby landmarks, educational institutes, and important road networks for smooth travel.



SITE ADDRESS : BIT MESRA, RANCHI



Chhotu Dhaba

Infinity Edge Swimming Pool

A designer pool experience with resort-style  
ambiance — where every swim feels like a vacation.

Kids' Splash Pool

A safe, beautifully designed shallow pool where little ones can play,  
splash, and enjoy carefree moments in a secure, resort-style setting.



Premium Quality Elevators



Smooth, fast, and efficient vertical mobility for effortless everyday convenience.



Dedicated Kids' Play Hall



Safe, vibrant, and thoughtfully designed areas, with glass walls visible from other amenities so you can always have peak at your cute young loved ones and also equipped with modern toys and equipments for children to play, learn, and grow.



Multipurpose Hall for your Special Events in Life



Elegant spaces for celebrations, gatherings, and community events.

### Café & Social Lounge

A stylish in-house café with outdoor / indoor seating designed for relaxed conversations, quick bites, and everyday indulgence — where every moment feels effortlessly premium.



### Luxury Clubhouse Beside Pool Area

A sophisticated social hub with indoor games, Café / lounges, and curated spaces for leisure and networking.



## Fully-Equipped Gymnasium

State-of-the-art fitness center with modern equipment — built for performance, wellness, and convenience.



## Wellness Hall

Dedicated large exotic hall for relaxation, rejuvenation, yoga and meditation for holistic well-being.



Green & serene surroundings with landscaped gardens & water features

Beautiful green spaces enhanced with water elements - creating a serene, resort-like environment. Beautifully crafted landscaped gardens / plantations and grass areas and open spaces - bringing nature closer to your everyday life.



Lighting elements in landscape

Elegant pathway lighting, decorative lamp posts, ambient garden illumination, and serene seating create a welcoming atmosphere.



## Indoor games & Recreation Lounge

A refined space for leisure and socializing - featuring billiards, table tennis, board games, and more in an elegant, club-style setting.



## Grand Main Entrance & Lobby

Luxurious marble-finished lobby, elegant lighting, premium wooden doors, and sophisticated interiors create a welcoming ambiance.



## Project Amenities



COMMUNITY HALL x 2



INFINITY SWIMMING POOL



KIDS' SPLASH POOL



POOLSIDE DECK



PREMIUM CAFÉ



INDOOR KIDS PLAY HALL

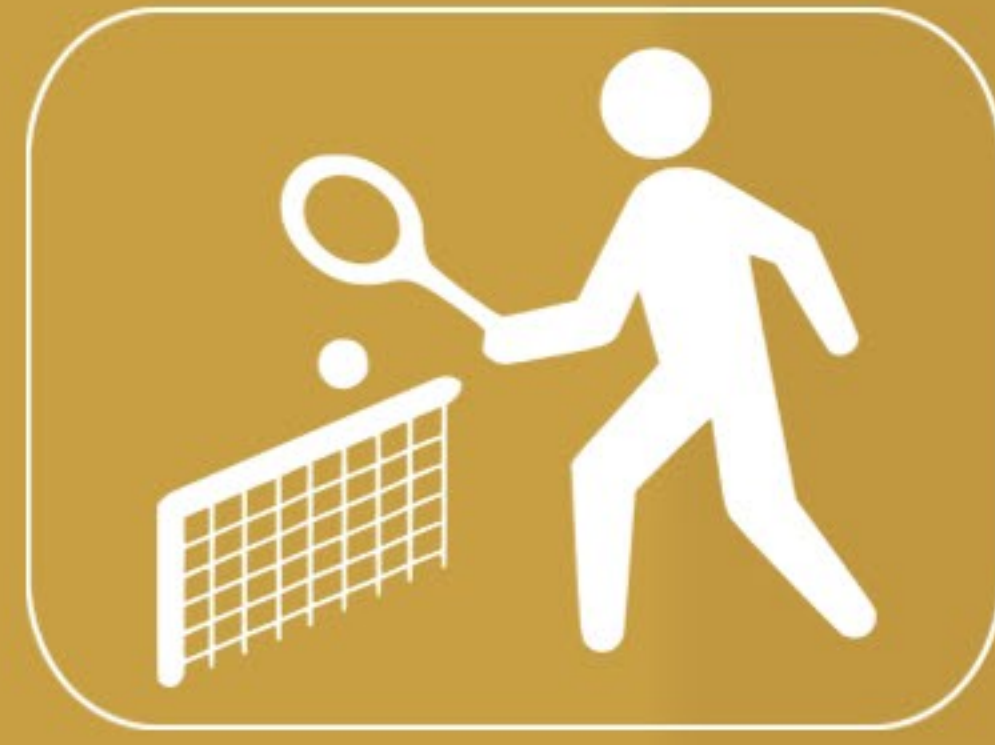

MULTIPURPOSE SPORTS COURT



FULLY EQUIPPED GYM



INDOOR GAMES HALL



GRAND MAIN ENTRANCE & LOBBY



ROOFTOP SEATING DECK



ROOFTOP GARDEN



ROOFTOP KIDS PLAY ZONE



YOGA / MEDITATION HALL



SENIOR CITIZEN SEATING

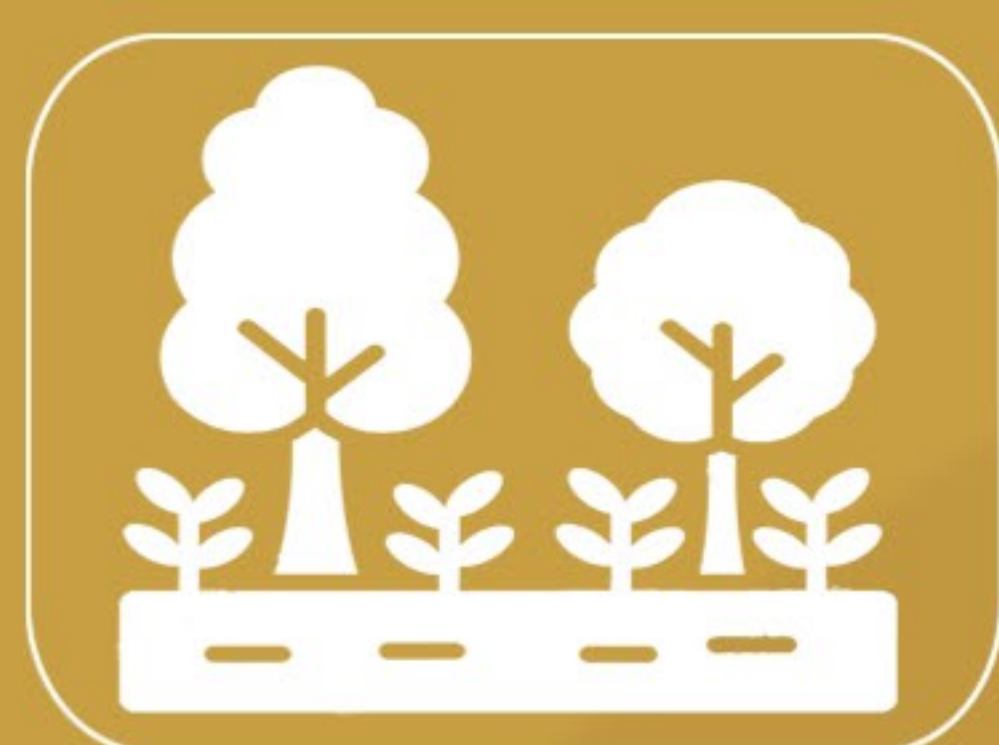

LANDSCAPE GARDEN



MODERN CLUBHOUSE



ECO-FRIENDLY LANDSCAPING

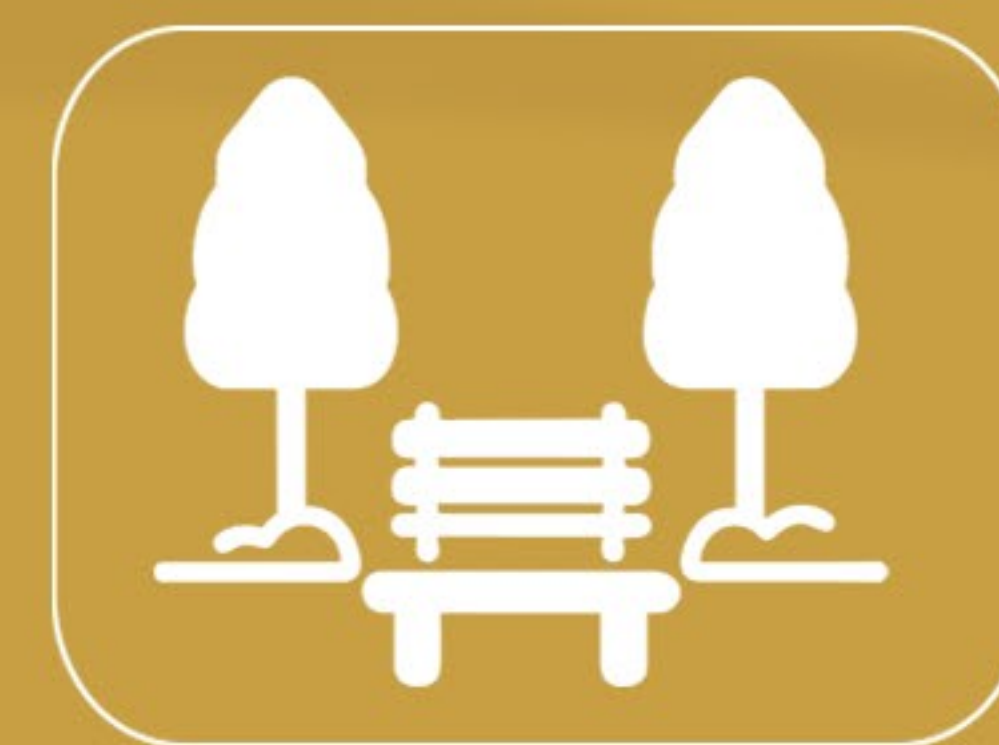

OUTDOOR SEATING AREA



CHILDREN ACTIVITY AREA



THE WALK



DECORATIVE WATERFALLS



CCTV SURVEILLANCE



BEAUTIFUL ENTRANCE



SECURITY GUARD

## Project Amenities



ELEVATOR



BASEMENT CAR PARKING



VISITOR PARKING SPACE

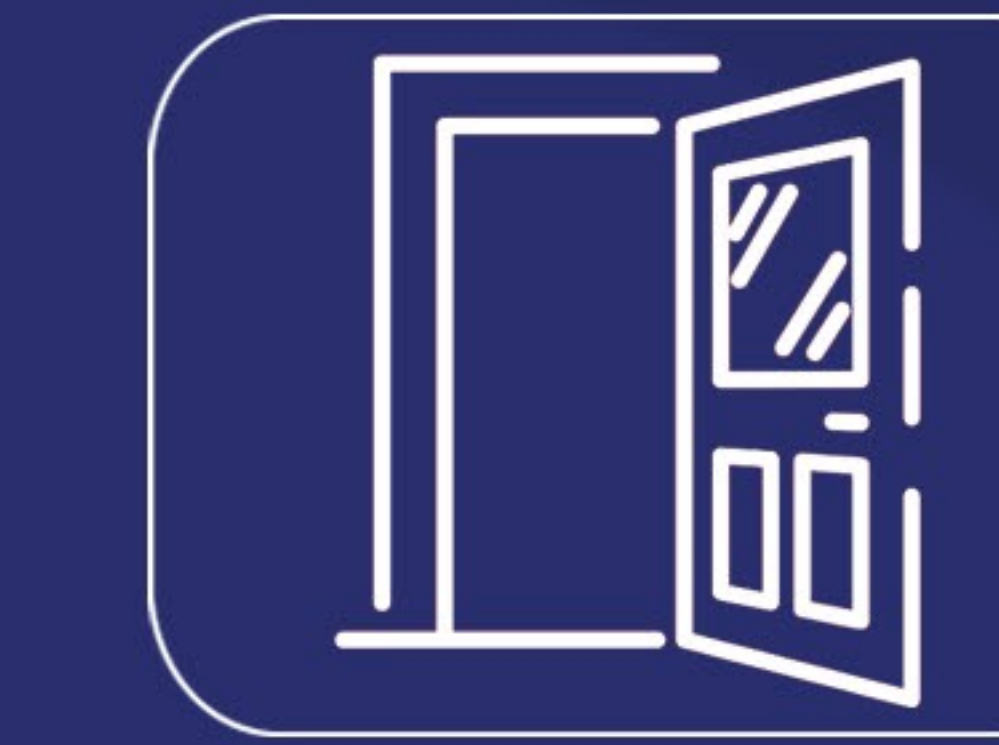

GRAND FLAT ENTRY DOORS



READING & LIBRARY CORNER



GRAND DRIVEWAY

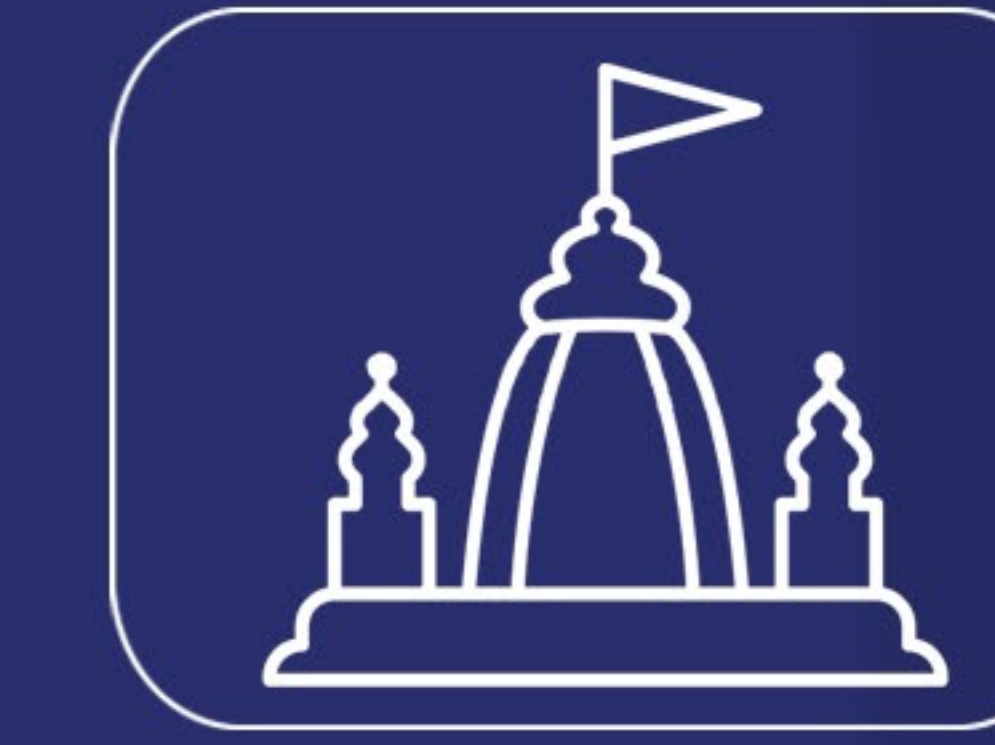

PEACEFULL TEMPLE WITH GARDEN



GAZEEBO



MODERN DRAINAGE SYSTEM



FIRE SAFETY SYSTEM

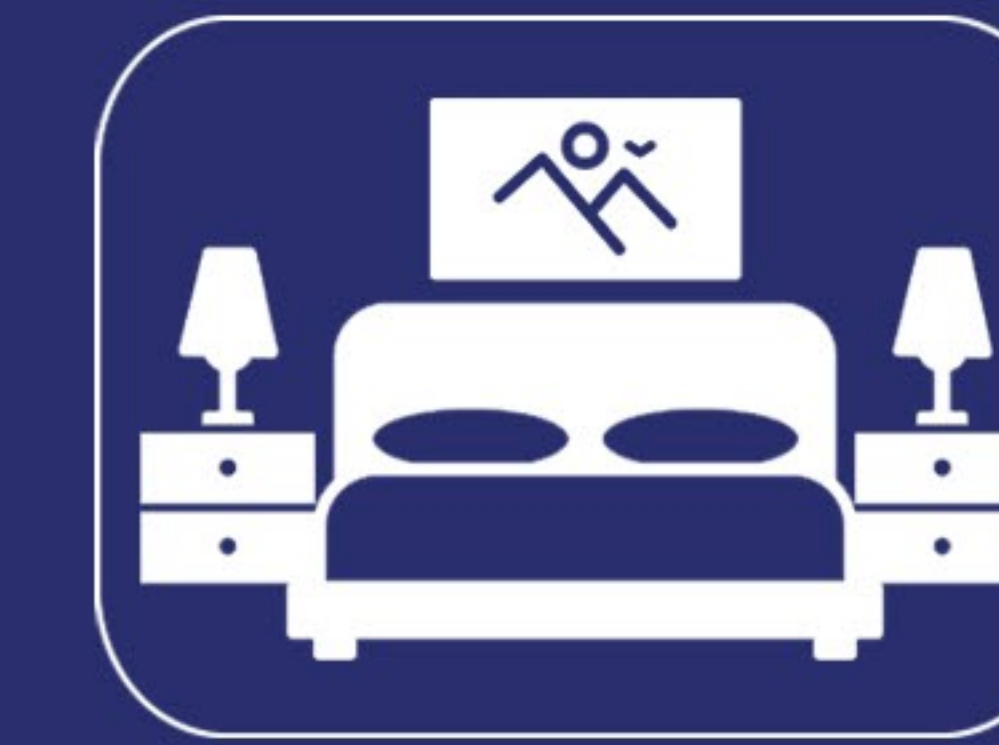

SPACIOUS BEDROOMS



SPACIOUS BATHROOMS



SPACIOUS CORRIDORS



LIGHTING ELMENTS  
IN LANDSCAPE



LIGHTING ELEMENTS  
ON BUILDING FACADE

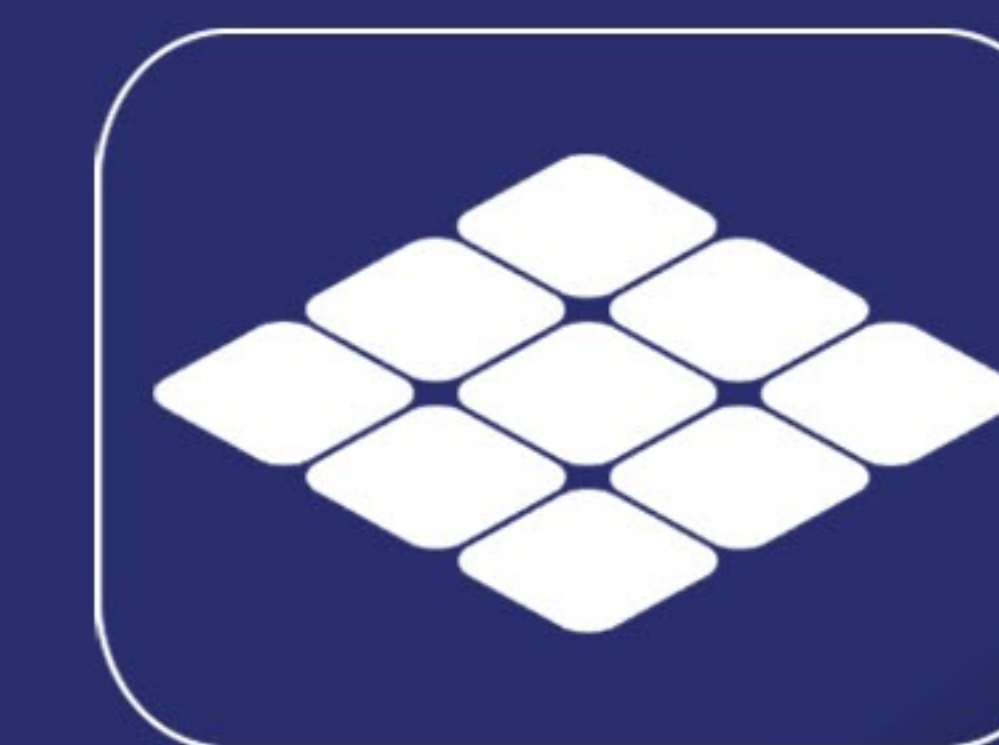

PREMIUM FLOORING



LUXURY AMENITIES INTERIORS



RECEPTION WITH LOUNGE



POWER BACKUP 24X7



WATER BORE WELL SYSTEM

### Elevated Living Redefined Daily

Parwati Towers offers a premium lifestyle with 45 thoughtfully curated amenities designed for comfort, wellness, recreation, and modern family living.

Featuring infinity pools, rooftop gardens, yoga halls, clubhouse spaces, cafés, sports courts, kids' activity zones, and elegant seating areas, every space reflects luxury and convenience.

Enhanced with elevators, CCTV surveillance, fire safety systems, landscaped gardens, spacious interiors, power backup, parking facilities, and peaceful temple spaces, Parwati Towers delivers a complete urban living experience.

Developer



**AADAYAE CONSTRUCTION PRIVATE LIMITED**

Krishna Chowk, Gola Road  
Danapur, Patna, Bihar - 801503

Suryansh Apartment Road, Near Vvps School,  
Chiraundi, Boreya, Ranchi, Jharkhand - 834006

Mobile

94717 10262 / 63982 92896 / 90605 46484

Email

aadayae.constructions@gmail.com

Website

www.aadayae.in

Architect & Consultant

**ENGINEER GROUP**

Near Govt. Girl's School  
Bariatu Road, Ranchi - 05

Mobile

+91 98351 17282 / 97091 44630 / 98353 22137

**RERA NO. : RRDA/BP/0776/2023**

Note: The Brochure is purely conceptual and note a legal Documents.